

FLOOR PLANS CAPACITY CHARTS

THE WESTIN
RIVERWALK
SAN ANTONIO



MEETING SPACE OVERVIEW

420 W Market Street
San Antonio, Texas 78205
T 210.224.6500 F 210.444.6000
E riverwalk@westin.com
westinriverwalksanantonio.com

THE WESTIN
RIVERWALK
SAN ANTONIO

BALLROOM LEVEL

1. HIDALGO BALLROOM
2. MADERO
3. CARRANZA
4. HIDALGO PREFUNCTION
5. NAVARRO BALLROOM
6. NAVARRO PREFUNCTION
7. VILLA
8. ZAPATA
9. PREFUNCTION
10. LA BABIA BOARDROOM
11. LA BABIA TERRACE
12. TERRACE

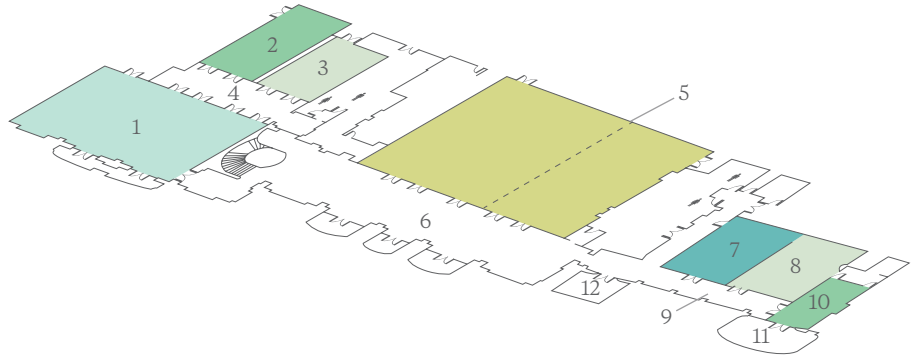

LOBBY LEVEL

1. LANTANA
2. ENCINO
3. SABINO
4. PREFUNCTION
5. LOGGIA I
6. LOGGIA II
7. EL RINCON
8. BUSINESS CENTER BOARDROOM
9. CAMINO REAL

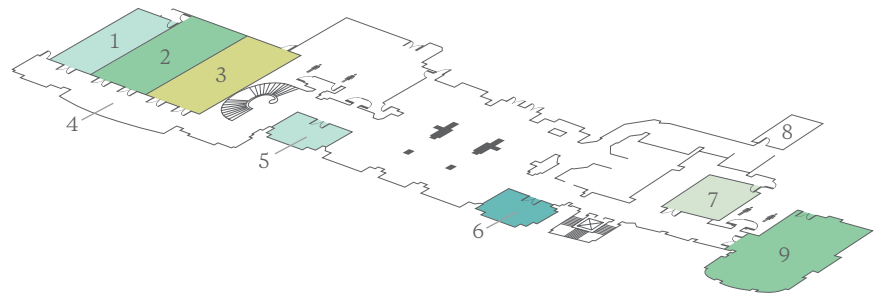

RIVER LEVEL

1. ZOCCA CUISINE D'ITALIA RESTAURANT
2. ZOCCA PATIO
3. GORAZ
4. OLIVARES
5. OLIVARES PATIO

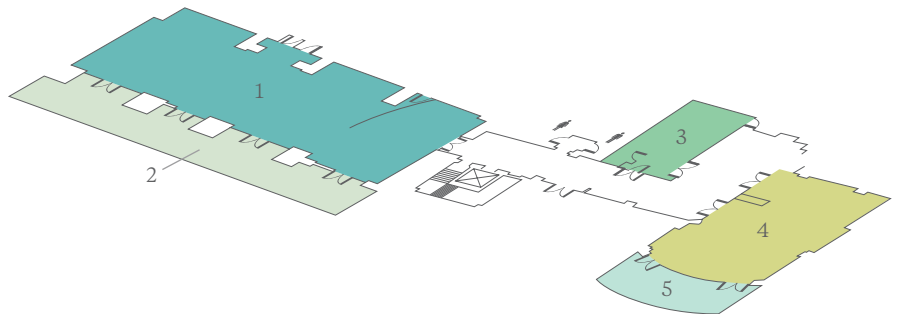

ROOMS AT A GLANCE

| | |
|-------------------------------|--|
| TOTAL GUEST ROOMS | 473 |
| TOTAL MEETING ROOMS | 16 |
| LARGEST MEETING ROOM CAPACITY | 784 |
| LARGEST MEETING ROOM SIZE | 548 m ² / 5,900 ft ² |

Additional spaces for meetings and events, not displayed here, may also be available. Contact your hotel representative for more information.

MEETING SPACE BALLROOM LEVEL

420 W Market Street
San Antonio, Texas 78205
T 210.224.6500 F 210.444.6000
E riverwalk@westin.com
westinriverwalksanantonio.com

THE WESTIN
RIVERWALK
SAN ANTONIO

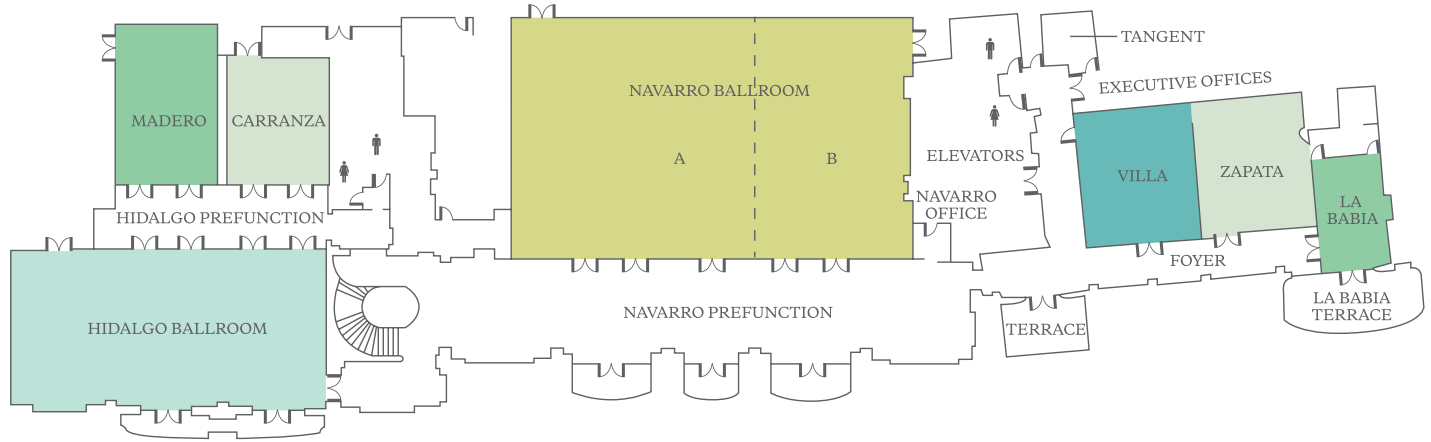

| | AREA (SQ. FT.) | DIMENSIONS | MAX CEILING HEIGHT | THEATER | SCHOOLROOM | CONFERENCE | U-SHAPE | HOLLOW SQ. | RECEPTION | ROUNDS |
|-----------------------|----------------|-------------|--------------------|---------|------------|------------|---------|------------|-----------|--------|
| ■ MADERO | 975 | 25' X 39' | 13' | 132 | 63 | 30 | 36 | 42 | 100 | 80 |
| ■ CARRANZA | 800 | 25' X 32' | 13' | 104 | 45 | 24 | 24 | 30 | 80 | 60 |
| ■ HIDALGO | 3,120 | 80' X 39' | 15' | 396 | 170 | 50 | 52 | 60 | 350 | 280 |
| ■ NAVARRO | 5,900 | 59' X 100' | 16' | 784 | 400 | 84 | 206 | 126 | 750 | 500 |
| ■ NAVARRO A | 3,599 | 59' X 61' | 16' | 510 | 243 | 54 | 72 | 96 | 450 | 300 |
| ■ NAVARRO B | 2,301 | 59' X 39' | 16' | 250 | 132 | 48 | 54 | 66 | 230 | 180 |
| ■ NAVARRO OFFICE | 70 | 10' X 7' | — | — | — | — | — | — | — | — |
| ■ NAVARRO PREFUNCTION | 3,100 | 124' X 25' | 16' | — | — | — | — | — | 250 | 200 |
| ■ TANGENT | 144 | 15' X 10.6' | 9' | — | — | 4 | — | — | — | — |
| ■ VILLA | 832 | 32' X 26' | 13' | 96 | 54 | 24 | 30 | 36 | 80 | 60 |
| ■ ZAPATA | 864 | 32' X 27' | 13' | 96 | 54 | 24 | 30 | 36 | 80 | 60 |
| ■ LA BABIA BOARDROOM | 476 | 28' X 17' | 11' | — | — | 14 | — | — | — | — |
| ■ LA BABIA TERRACE | 400 | — | — | — | — | — | — | — | 40 | 30 |

This document contains approximate measurements and square footage that are for illustrative purposes only. We cannot guarantee the floor plan accuracy or completeness, therefore encourage you to review the space to make sure it is suitable for your event.

MEETING SPACE LOBBY LEVEL

420 W Market Street
San Antonio, Texas 78205
T 210.224.6500 F 210.444.6000
E riverwalk@westin.com
westinriverwalksanantonio.com

THE WESTIN
RIVERWALK
SAN ANTONIO

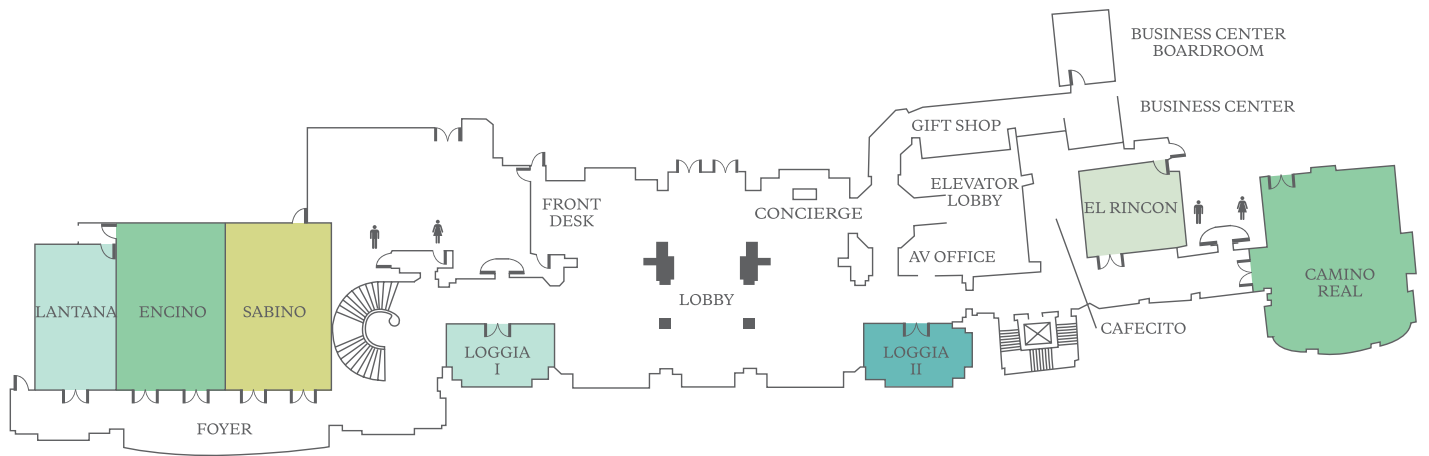

| | AREA (SQ. FT.) | DIMENSIONS | MAX CEILING HEIGHT | THEATER | SCHOOLROOM | CONFERENCE | U-SHAPE | HOLLOW SQ. | RECEPTION | ROUNDS |
|---------------------------|----------------|---------------|--------------------|---------|------------|------------|---------|------------|-----------|--------|
| ■ LANTANA | 760 | 20' X 38' | 12' | 90 | 42 | 30 | 30 | 34 | 70 | 60 |
| ■ ENCINO | 1,134 | 27' X 42' | 12' | 120 | 72 | 36 | 36 | 42 | 100 | 90 |
| ■ SABINO | 1,050 | 25' X 42' | 12' | 120 | 72 | 36 | 36 | 42 | 100 | 80 |
| ■ LOGGIA I | 349.8 | 26.5' X 13.2' | 11.4' | — | — | — | — | — | — | — |
| ■ LOGGIA II | 347.2 | 26.3' X 13.2' | 11.3' | — | — | — | — | — | — | — |
| BUSINESS CENTER BOARDROOM | 285 | 15' X 19' | 10' | — | — | 8 | — | — | — | — |
| ■ EL RINCON | 504 | 21' X 24' | 11.6' | 45 | 24 | 16 | 18 | 24 | 50 | 40 |
| ■ CAMINO REAL | 1,470 | 42' X 35' | 11.6' | 146 | 84 | 34 | 38 | 40 | 130 | 110 |

This document contains approximate measurements and square footage that are for illustrative purposes only. We cannot guarantee the floor plan accuracy or completeness, therefore encourage you to review the space to make sure it is suitable for your event.

MEETING SPACE RIVER LEVEL

420 W Market Street
San Antonio, Texas 78205
T 210.224.6500 F 210.444.6000
E riverwalk@westin.com
westinriverwalksanantonio.com

THE WESTIN
RIVERWALK
SAN ANTONIO

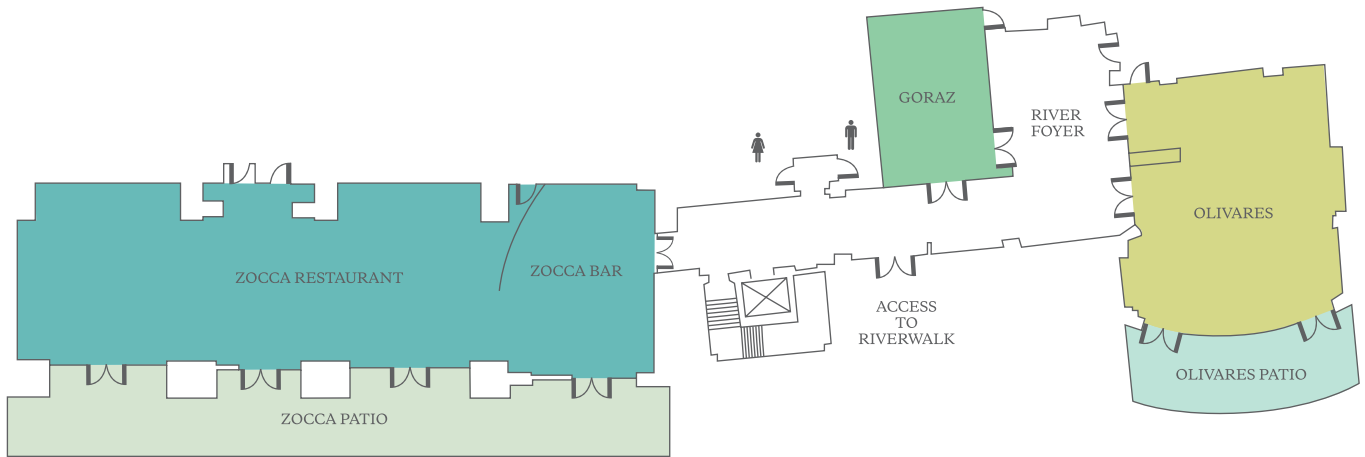

| | AREA (SQ. FT.) | DIMENSIONS | MAX CEILING HEIGHT | THEATER | SCHOOLROOM | CONFERENCE | U-SHAPE | HOLLOW SQ. | RECEPTION | ROUNDS |
|------------------|----------------|-------------|--------------------|---------|------------|------------|---------|------------|-----------|--------|
| ■ ZOCCA PATIO | 1,550 | — | — | — | — | — | — | — | 100 | 50 |
| ■ GORAZ | 486 | 18' X 27' | 11.6' | 56 | 30 | 24 | 24 | 30 | 40 | 40 |
| ■ RIVER FOYER | 352.5 | 18' X 27' | 11.6' | — | — | — | — | — | — | — |
| ■ OLIVARES | 1,400 | 40' X 35' | 11.6' | 140 | 77 | 36 | 36 | 42 | 130 | 100 |
| ■ OLIVARES PATIO | 410 | 8.75' X 35' | — | — | — | — | — | — | 60 | 20 |

This document contains approximate measurements and square footage that are for illustrative purposes only. We cannot guarantee the floor plan accuracy or completeness, therefore encourage you to review the space to make sure it is suitable for your event.



420 W Market Street
San Antonio, Texas 78205
T 210.224.6500 F 210.444.6000
E riverwalk@westin.com
westinriverwalksanantonio.com

THE WESTIN
RIVERWALK
SAN ANTONIO